

Residential



Raj Lakeview Phase II

Commercial



SNN Plaza

Residential



Raj Lakeview

Commercial



Raj Paradise



Raj Pinnacle

"We cannot seek achievement for ourselves and forget about progress and prosperity for our community... Our ambitions must be broad enough to include the aspirations and needs of others, for their sakes and for our own." This is the inspirational quote that drives everything we do for our customers, our staff, our partners, and the society at large.

Established in 1994, SNN Builders has to its credit many prestigious completed residential projects in Bangalore. **Raj Meridien, Raj Paradise, Raj Lakeview** are a few among them. And the list is set to steadily grow. SNN Raj Serenity is an irresistible idea from both, the stay-in and investment perspectives considering the location, quality, pricing and lifestyle amenities that are truly the best in class.

Allow us to fulfill your aspiration of owning a dream home. Our doors are open to a lasting relationship.



SNN Builders Pvt. Ltd

Site Address:

SNN Raj Serenity, Survey No. 40, Begur Main Road, Yelenahalli Village, Begur Hobli, Bangalore - 560 045

E-mail: rajserenity@snnbuilders.com | www.snnbuilders.com

Ph: 9739 444 444 / 9740 152 002 / 9740 134 009

This brochure is only a conceptual presentation of the project not legal offering. The developers reserve the right to make change in the elevation, plans and specifications as deemed fit.

SNN Builders Pvt. Ltd.

www.snnbuilders.com



OWN A SWEET HOME?

You can



SNN Raj Serenity

Begur Main Road, off Bannerghatta Road

Serene, Picturesque & Unpolluted Living Spaces

You Can.

Your home means timeless contentment with **SNN Raj Serenity**. It is all about what you desired all along. A setting that inspires in many a way. Prodding your heart to sing, liberating your mind. And being truly big-hearted on price, it is the answer you have been longing to hear: "You can."

- World class Amenities
- 3 sides Open Apartments
- Vaastu Compliant
- Natural and Man Made Lakes

About the project

SNN Raj Serenity is a spectacular residential development with a selection of 2000 deluxe apartments, spread over 30 acres of lush green space. The project is amidst a Natural and an Artificial Lake enveloped by charming tranquility and vast open space.

- Project amidst a natural and a man-made Lakes
- Located on Begur Koppa Main Road with easy access to Electronic City
- Home opposite to Meenakshi Temple, Bannerghatta Road
- Easy access to Schools, Malls, Restaurants and Hospitals
- All the Blocks are spread out well, with **Three Sides Open Apartments**
- Design as per **Vaastu**
- 80% Open lung space
- World Class Amenities
- Quality – assured by SNN Builders
- Project approved by major Financial Institutions

World class amenities

SNN Raj Serenity packs in an irresistible range of amenities, what you would otherwise expect only from a premium home. A lifestyle clearly meant to be envied. Playground, walkway, swimming pool, supermarket, club house... Welcome to play the cheerful life day after day.



The Club Serenity 40,000 sq. ft. Club House with:

- Swimming Pool with a Toddler Section
- Fully Equipped Gym
- World-Class Health Clubs (Separate for ladies & gents)
- Steam, Sauna & Jacuzzi and Massage
- Tennis Court
- Indoor Badminton Court
- Basketball Court
- Children's Play Area / Park
- Party Halls
- Recreation zone with Carrom, Chess, TT, etc.
- Amphitheatre
- Water Fountains & Sculpture Courts
- Rain Water Harvesting
- Reticulated Gas Pipeline
- Provision for Library
- Jogging Track
- Shopping Complex
- Power Back-up
- Water Treatment Plant
- Well laid-out internal roads
- BBQ area
- Provision for Play School
- Landscaped Gardens
- Advanced Security Systems

Master Plan



- A to E** Apartment Blocks
- F** Shopping Complex
- G** World Class Club House
- H** Tennis Court (2 Nos)
- I** Badminton Court
- J** Basket Ball Court
- K** Swimming pool with waterbody & amenities
- L** Grand Entry
- M** Pathway Feature
- N** Open Air Theatre
- O** Childrens play area with sandpit
- P** Elders Park
- Q** Artificial Lake
- Sculptures / Ornamental Tree

Meticulously Designed Floor Spaces

Typical Floor Plan - 2 BedRoom
1260 sq. ft.

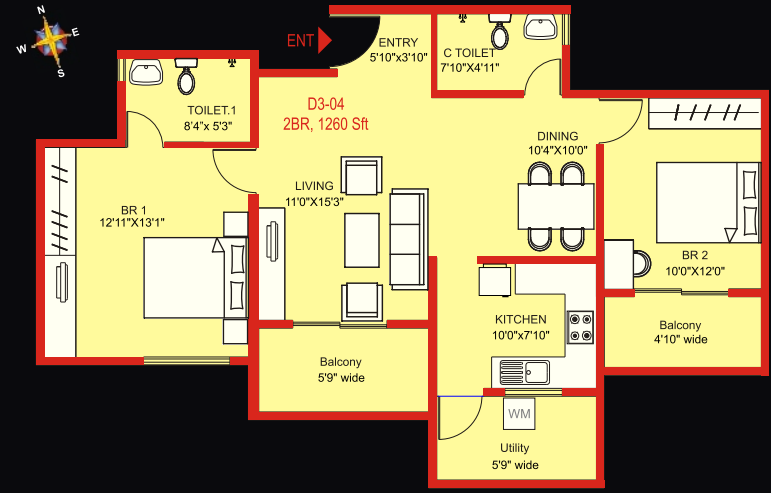

Typical Floor Plan - 3 BedRoom
1600 sq. ft.

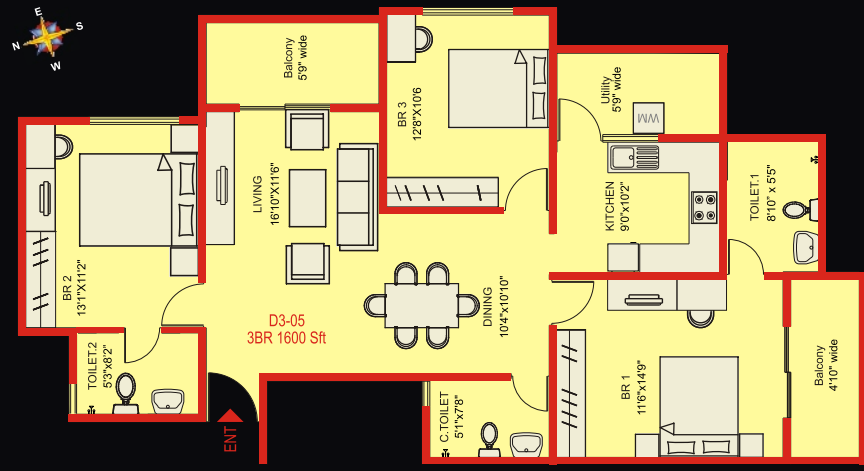

Design of distinction

SNN Raj Serenity is about everything very thoughtfully chosen, right down to the screws and nails.



Actual Model Apartment Photographs

Specifications

- Plastering** : Internal walls smoothly plastered with lime rendering. External walls plastered with sponge finish.
- Painting** : Internal walls painted with Acrylic emulsion. External walls with exterior grade emulsion paint.
- Main Door** : Hardwood frame with Moulded flush shutter and powder coated Hinges & Hardware.
- Other Doors** : Hardwood frame with flush shutters enamel painted and powder coated Hinges & Hardware.
- Windows** : Powder coated Aluminum/UPVC windows with Mosquito Mesh.
- Ventilators** : Powder Coated Aluminum/UPVC windows with provision for exhaust fan.
- Flooring** : Living/Dining/Kitchen/Bedrooms with good quantity vitrified tiles.
- Kitchen** : Granite counter with Stainless steel sink, 2'0" high Ceramic tile Daddoing.
- Toilets** : Glazed Ceramic tile Daddoing upto 7'0" high with anti-skid ceramic tile flooring.
- Balcony** : Quality anti-skid Ceramic tile.

Advantages of location

SNN Raj Serenity is located on Begur Main Road with excellent connectivity to Jigani Industrial Area in Electronic City, with access to NICE corridor in close proximity. Also Bommanahalli Junction, HSR Layout and Koramangala are within a very short drive.

A location highly coveted from the residential perspective for the various reasons. JP Nagar, Jayanagar and BTM Layout being the nearby areas.

